

PX 501W High Performance Mig Fume Torch Range

Rating: 500A CO 2 , 450A mixed gas M21, EN60974-7 @ 100% duty cycle.0.9 to 1.6mm wires

Liquid-Cooled Mig Welding Torch

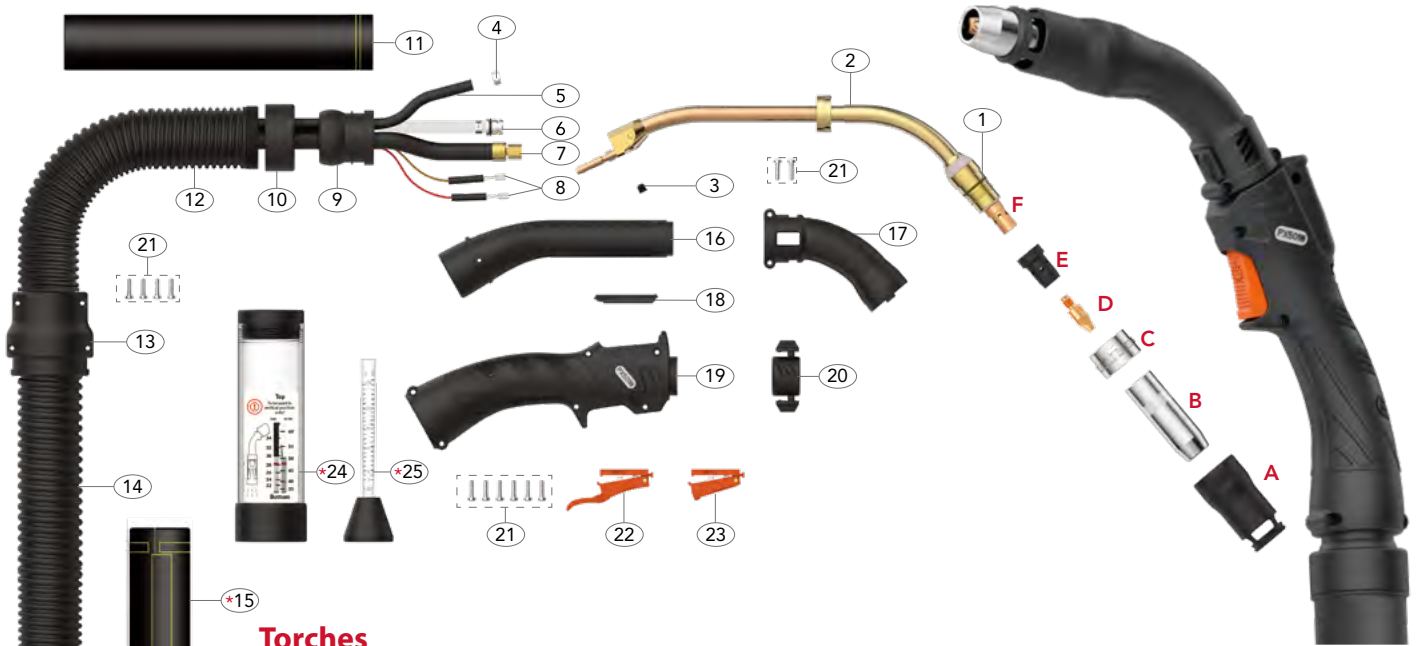

Torches

| Description | Part No. | | |
|---|-----------------|-----------------|-----------------|
| | 3mt | 4mt | 5mt |
| Fume Torch c/w Front Leather | PX501W-3M | PX501WA-4M | PX501W-5M |
| Fume Torch c/w Front Leather, Air Flow and Gas Flow Meter | PX501W-3M-FM | PX501WA-4M-FM | PX501W-5M-FM |
| Fume Torch Full Leather | PX501W-3M-LE | PX501W-4M-LE | PX501W-5M-LE |
| Fume Torch Full Leather c/w Air Flow and Gas Flow Meter | PX501W-3M-LE-FM | PX501W-4M-LE-FM | PX501W-5M-LE-FM |

Wear Parts

A Fume Nozzles

| Part No. | Description | Bore | Wall | Material |
|----------|-------------|------|-------|-----------|
| PBX3FN | Fume Nozzle | 23.4 | 1.0mm | Aluminium |

B Nozzles

| Part No. | Description | Bore | Wall | Material |
|----------|--------------------|------|-------|----------|
| PBX3TN | Tapered Nozzle | 12.0 | 2.5mm | Copper |
| *PBX3CN | Conical Nozzle | 15.0 | 2.5mm | Copper |
| PBX3CYN | Cylindrical Nozzle | 18.0 | 2.5mm | Copper |

C Fume Adaptors

| Part No. | Description | Material |
|----------|---------------------|-----------|
| PBX3002 | Fume Nozzle Adaptor | Aluminium |

D Contact Tips

| Part No. | Description | Material | Wire Size | |
|------------|-------------|----------|-----------|--------|
| | | | mm | Inch |
| PB4014-10 | Contact Tip | Cu | 1.0 | 0.040" |
| PB4014-12 | Contact Tip | Cu | 1.2 | 0.045" |
| PB4014-16 | Contact Tip | Cu | 1.6 | 0.063" |
| *PB4015-12 | Contact Tip | CuCrZr | 1.2 | 0.045" |
| PB4015-16 | Contact Tip | CuCrZr | 1.6 | 0.063" |

E Diffusers

| Part No. | Description | Colour | Material |
|----------|-------------|--------|----------|
| PB5005B | Diffuser | Black | DMC3 |
| PB5005C | Diffuser | White | Ceramic |
| PB5005W | Diffuser | White | DMC3 |
| *PB5005H | Diffuser | Black | HPP |

F Tip Adaptors

| Part No. | Description | Material |
|----------|------------------|----------|
| PB5001 | Tip Adaptor | Brass |
| *PB5001C | Tip Adaptor | CuCrZr |
| PB5001L | Tip Adaptor Long | Brass |

G Liners

| Part No. | Description | Length | Wire Size | |
|------------|-------------------|--------|-----------|------|
| | | | mm | Inch |
| *PB2524-30 | Steel Liner x 3mt | 3.4mt | 1.0-1.2 | |
| *PB2524-40 | Steel Liner x 4mt | 4.4mt | 1.0-1.2 | |
| *PB2524-50 | Steel Liner x 5mt | 5.4mt | 1.0-1.2 | |

Volume Flow Rate

| | |
|--------------------|----------------------|
| Extractor Nozzle | 52 m ³ /h |
| Connector | 66 m ³ /h |
| Pressure Drop | 10 kPa |
| Efficiency | 93% |
| Shielding Gas Flow | 16-22 l/min |



PX 501W High Performance Mig Fume Torch Range

Rating: 500A CO 2 , 450A mixed gas M21, EN60974-7 @ 100% duty cycle.0.9 to 1.6mm wires

Liquid-Cooled Mig Welding Torch



Spare Parts

| Part No. | Description |
|----------|---|
| 1 | PBX3-NOR Neck'O'Ring |
| 2 | PBX5002 Swan Neck Assembly |
| 3 | PAM6X5 Outer Liner Retaining Screw |
| 4 | 15400023 Water Hose Clamp 10mm |
| 9 | PBX8015-1 Ball Joint |
| 10 | PBX8015-2 Ball Joint Nut |
| 11 | PBXLC-32 x 1.5M Front Leather Cover 1.5mt |
| 12 | PBX5019-1 Front Extract Hose Assembly |
| 13 | PBX-HRC32-40 Hose Connector |
| 16 | PBX3-IFC Inner Fume Chamber |
| 17 | PBX3-OFC Outer Fume Chamber |
| 18 | PB2514-C Handle Control Cover |
| 19 | PBX2514 Fume Handle Assembly |

| Part No. | Description |
|----------|---------------------------------------|
| 20 | PBX3-AFR Air Flow Regulator |
| 21 | AXSP1-1 Screw Pack |
| 22 | PBX2516L Microswitch Extended Trigger |
| 23 | PBX2516 Microswitch Standard Trigger |

Optional

| | | |
|-----|-----------------|---------------------------|
| *15 | PXLC-40 x 0.75M | Rear Leather Cover 0.75mt |
| | PXLC-40 x 1.75M | Rear Leather Cover 1.75mt |
| | PXLC-40 x 2.75M | Rear Leather Cover 2.75mt |
| *24 | PBX3-AFM | Air Flow Meter |
| *25 | PBX-GFM | Gas Flow Meter |

Cable Parts

| Description | Part No. | | |
|-------------------------------|--------------|--------------|--------------|
| | 3mt | 4mt | 5mt |
| 5 Water Inlet Hose Assembly | PBX5012-30 | PBX5012-40 | PBX5012-50 |
| 6 Outer Liner Assembly | PBX5008-30 | PBX5008-40 | PBX5008-50 |
| 7 Power Cable Assembly | PBX5015-30 | PBX5015-40 | PBX5015-50 |
| 8 Switch Lead Assembly | PBX5010-30 | PBX5010-40 | PBX5010-50 |
| 14 Rear Extract Hose Assembly | PBX5019-2-30 | PBX5019-2-40 | PBX5019-2-50 |