

# PX 250A High Performance Mig Fume Torch Range

Rating: 250A CO<sub>2</sub>, 220A mixed gas M21, EN60974-7 @ 60% duty cycle. 0.8 to 1.2mm wires

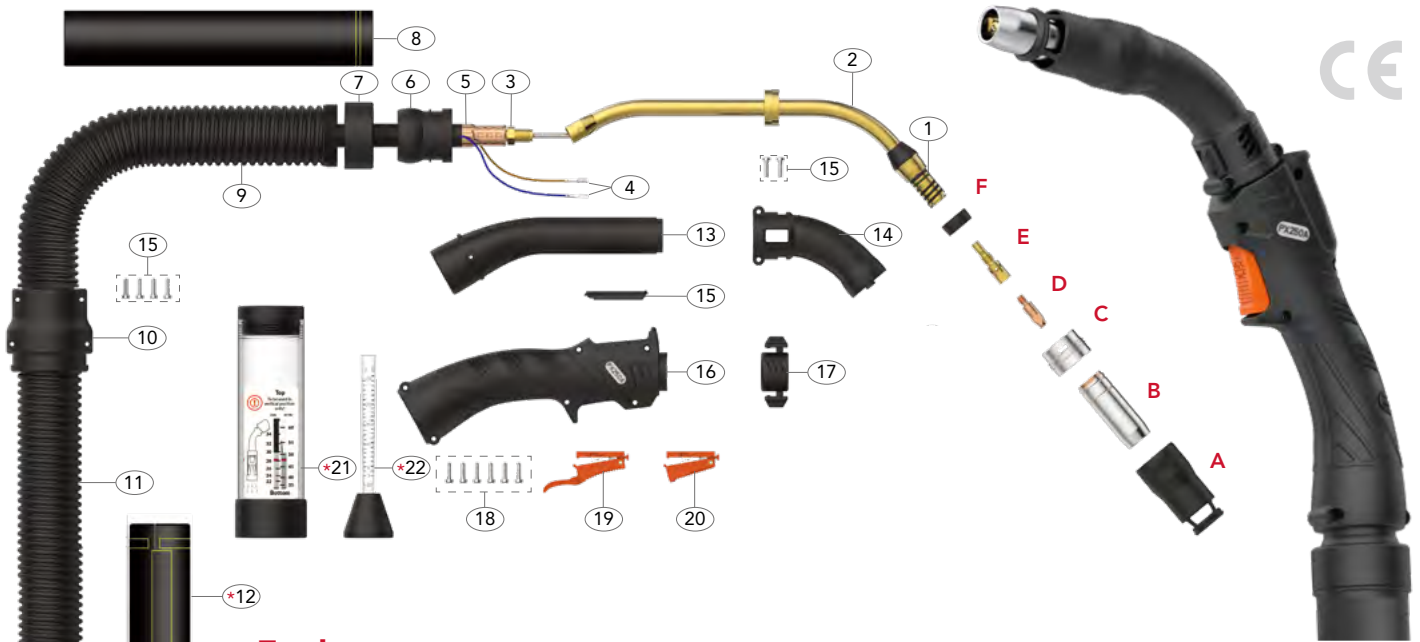

## Torches

Description	Part No.		
	3mt	4mt	5mt
Fume Torch c/w Front Leather	PX250A-3M	PX250A-4M	PX250A-5M
Fume Torch c/w Front Leather, Air Flow and Gas Flow Meter	PX250A-3M-FM	PX250A-4M-FM	PX250A-5M-FM
Fume Torch Full Leather	PX250A-3M-LE	PX250A-4M-LE	PX250A-5M-LE
Fume Torch Full Leather c/w Air Flow and Gas Flow Meter	PX250A-3M-LE-FM	PX250A-4M-LE-FM	PX250A-5M-LE-FM

## Wear Parts

### A Fume Nozzles

Part No.	Description	Bore	Wall	Material
PBX2FN	Fume Nozzle	23.4	1.0mm	Aluminium

### B Nozzles

Part No.	Description	Bore	Wall	Material
PB2507	Cylindrical Nozzle	18.0	1.5mm	Cu
*PB2508	Conical Nozzle	15.0	1.5mm	Cu
PB2509	Tapered Nozzle	12.0	1.5mm	Cu
PB2510	Bottle Nozzle	14.5	1.5mm	Cu
PB2511	Spot Welding Nozzle	18.0	1.5mm	Cu

### C Fume Adaptors

Part No.	Description	Material
PBX2002	Fume Nozzle Adaptor	Aluminium

### D Contact Tips M8

Part No.	Description	Material	Wire Size	
			mm	Inch
PB2504-08	Contact Tip	Cu	0.8	0.030"
*PB2504-10	Contact Tip	Cu	1.0	0.040"
PB2504-12	Contact Tip	Cu	1.2	0.045"
PB2504-10A	Contact Tip	Cu	1.0	0.040"
PB2504-12A	Contact Tip	Cu	1.2	0.045"

Part No.	Description	Material	Wire Size	
			mm	Inch
PB2505-08	Contact Tip	CuCrZr	0.8	0.030"
PB2505-10	Contact Tip	CuCrZr	1.0	0.040"
PB2505-12	Contact Tip	CuCrZr	1.2	0.045"
PB2505-10A	Contact Tip	CuCrZr	1.0	0.040"
PB2505-12A	Contact Tip	CuCrZr	1.2	0.045"

### E Tip Adaptors

Part No.	Description	Material
*PB2506	Tip Adaptor	Brass
PB2536	Tip Adaptor M8	Brass

### F Neck Insulator

Part No.	Description	Material
PBX2003	Neck Insulator	Aluminium

### Volume Flow Rate

Extractor Nozzle	48 m <sup>3</sup> /h
Connector	56 m <sup>3</sup> /h
Pressure Drop	6.03 kPa
Efficiency	93%
Shielding Gas Flow	10-15 l/min

# PX 250A High Performance Mig Fume Torch Range

Rating: 250A CO<sub>2</sub>, 220A mixed gas M21, EN60974-7 @ 60% duty cycle.0.8 to 1.2mm wires

Air-Cooled Mig Welding Torch

## Spare Parts

Part No.	Description
1	PBX2-NOR Neck'O'Ring
2	PBX2501 Swan Neck Assembly
3	PB1505 Lock Nut
4	PB1521 Cable Terminal
5	PBX2503-30 Power Cable Assembly x 3mt
	PBX2503-40 Power Cable Assembly x 4mt
	PBX2503-50 Power Cable Assembly x 5mt
6	PBX8015-1 Ball Joint
7	PBX8015-2 Ball Joint Nut
8	PXLC-30 x 1.5M Front Leather Cover 1.5mt
9	PBX4019-1 Front Extract Hose Assembly
10	PBX-HRC30-40 Hose Connector
11	PBX5019-2-30 Rear Extract Hose Assembly x 3mt
	PBX5019-2-40 Rear Extract Hose Assembly x 4mt
	PBX5019-2-50 Rear Extract Hose Assembly x 5mt
13	PBX3-IFC Inner Fume Chamber
14	PBX2-OFC Outer Fume Chamber
15	PB2514-C Handle Control Cover

Part No.	Description
16	PBX2514 Fume Handle Assembly
17	PBX3-AFR Air Flow Regulator
18	AXSP1-1 Screw Pack
19	PBX2516L Microswitch Extended Trigger
20	PBX2516 Microswitch Standard Trigger

### Optional

*12	PXLC-40 x 0.75M	Rear Leather Cover 0.75mt
	PXLC-40 x 1.75M	Rear Leather Cover 1.75mt
	PXLC-40 x 2.75M	Rear Leather Cover 2.75mt
*21	PBX2-AFM	Air Flow Meter
*22	PBX-GFM	Gas Flow Meter

### G Liners

Part No.	Description	Length	Wire Size mm
*PB2524-30	Steel Liner x 3mt	3.4mt	1.0-1.2
*PB2524-40	Steel Liner x 4mt	4.4mt	1.0-1.2
*PB2524-50	Steel Liner x 5mt	5.4mt	1.0-1.2