

PX 150A High Performance Mig Fume Torch Range

Rating: 180A CO₂, 150A mixed gas M21, EN60974-7 @ 60% duty cycle.0.6 to 1.0mm wires
Air-Cooled Mig Welding Torch

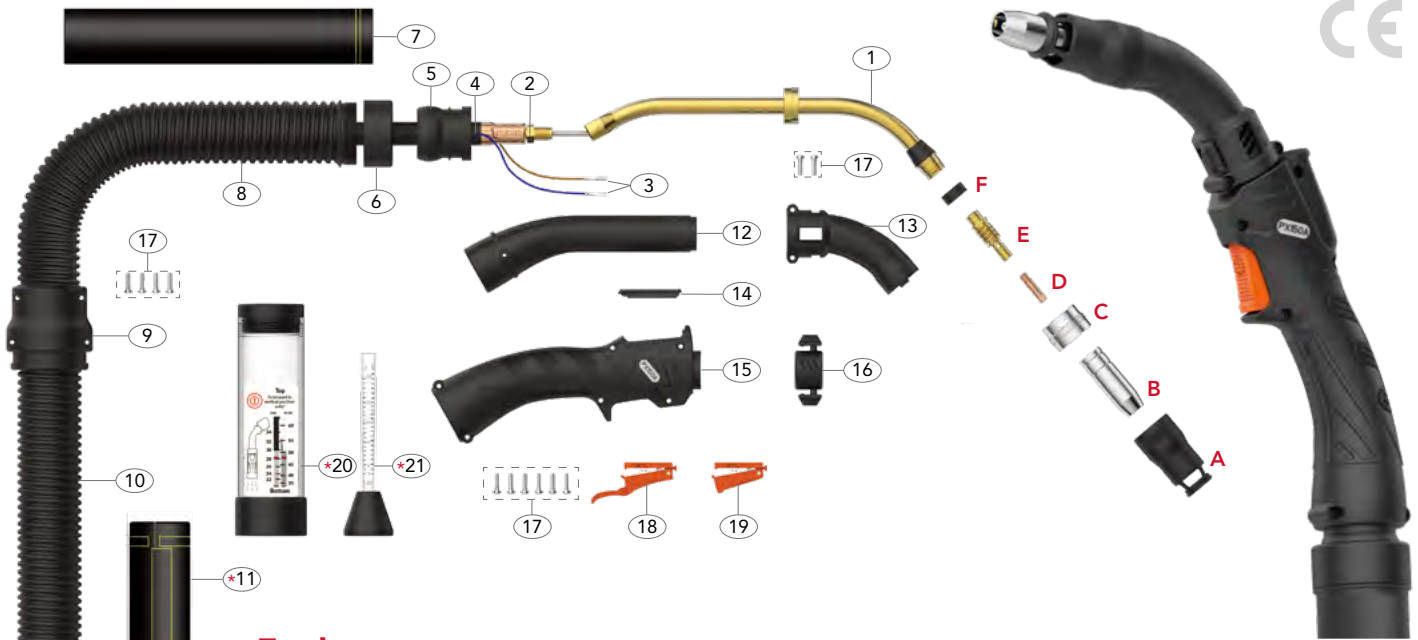

Torches

Description	Part No.		
	3mt	4mt	5mt
Fume Torch c/w Front Leather	PX150A-3M	PX150A-4M	PX150A-5M
Fume Torch c/w Front Leather, Air Flow and Gas Flow Meter	PX150A-3M-FM	PX150A-4M-FM	PX150A-5M-FM
Fume Torch Full Leather	PX150A-3M-LE	PX150A-4M-LE	PX150A-5M-LE
Fume Torch Full Leather c/w Air Flow and Gas Flow Meter	PX150A-3M-LE-FM	PX150A-4M-LE-FM	PX150A-5M-LE-FM

Wear Parts

A Fume Nozzles

Part No.	Description	Bore	Wall	Material
PBX1FN	Fume Nozzle	23.0	1.0mm	Aluminium

B Nozzles

Part No.	Description	Bore	Wall	Material
PB1529	Cylindrical Nozzle	16.0	0.9mm	Cu
*PB1530	Conical Nozzle	12.0	0.9mm	Cu
PB1531	Tapered Nozzle	10.5	0.9mm	Cu
PB1532	Bottle Nozzle	12.8	0.9mm	Cu
PB1533	Spot Welding Nozzle	16.0	0.9mm	Cu

C Fume Adaptors

Part No.	Description	Material
PBX1002	Fume Nozzle Adaptor	Aluminium

D Contact Tips

Part No.	Description	Material	Wire Size	
			mm	Inch
PB1527-06	Contact Tip	Cu	0.6	0.023"
*PB1527-08	Contact Tip	Cu	0.8	0.030"
PB1527-09	Contact Tip	Cu	0.9	0.035"
PB1527-10	Contact Tip	Cu	1.0	0.040"

E Tip Adaptors

Part No.	Description	Material
*PB1507LH	Tip Adaptor Left Hand	Brass

F Neck Insulator

Part No.	Description	Material
PBX1003	Neck Insulator	Aluminium

G Liners

Part No.	Description	Length	Wire Size
*PB1535-30	Steel Liner x 3mt	3.4mt	0.6-0.9
*PB1535-40	Steel Liner x 4mt	4.4mt	0.6-0.9
*PB1535-50	Steel Liner x 5mt	5.4mt	0.6-0.9

Volume Flow Rate

Extractor Nozzle	41 m ³ /h
Connector	50.9 m ³ /h

Pressure Drop 5.26 kPa

Efficiency 93%

Shielding Gas Flow 10-13 l/min

PX 150A High Performance Mig Fume Torch Range

Rating: 180A CO₂, 150A mixed gas M21, EN60974-7 @ 60% duty cycle.0.6 to 1.0mm wires

Air-Cooled Mig Welding Torch



Spare Parts

Part No.	Description
1	PBX1501 Swan Neck Assembly
2	PB1505 Lock Nut
3	PB1521 Cable Terminal
4	PBX1517-30 Power Cable Assembly x 3mt
	PBX1517-40 Power Cable Assembly x 4mt
	PBX1517-50 Power Cable Assembly x 5mt
5	PBX8015-1 Ball Joint
6	PBX8015-2 Ball Joint Nut
7	PXLC-30 x 1.5M Front Leather Cover 1.5mt
8	PBX4019-1 Front Extract Hose Assembly
9	PBX-HRC30-40 Hose Connector
10	PBX5019-2-30 Rear Extract Hose Assembly x 3mt
	PBX5019-2-40 Rear Extract Hose Assembly x 4mt
	PBX5019-2-50 Rear Extract Hose Assembly x 5mt
12	PBX3-IFC Inner Fume Chamber
13	PBX1-OFC Outer Fume Chamber
14	PB2514-C Handle Control Cover

Part No.	Description
15	PBX2514 Fume Handle Assembly
16	PBX3-AFR Air Flow Regulator
17	AXSP1-1 Screw Pack
18	PBX2516L Microswitch Extended Trigger
19	PBX2516 Microswitch Standard Trigger

Optional

*11	PXLC-40 x 0.75M	Rear Leather Cover 0.75mt
	PXLC-40 x 1.75M	Rear Leather Cover 1.75mt
	PXLC-40 x 2.75M	Rear Leather Cover 2.75mt
*20	PBX1-AFM	Air Flow Meter
*21	PBX-GFM	Gas Flow Meter