

FUME
MIG/MAG SERIES



Advanced Fume Torches for the Professional

A Smart Approach

Parker Torchology is shaped by people with vision, a passion for improvement and a belief in delivering the very best Welding and Cutting Torch Range in the World.

We expect a great deal from our products, so we ask a lot of ourselves and our engineers.

Our mantra: **Innovation, Technology, Performance.**



DNA

Design and Engineering excellence are at the core of everything we do.

Every torch we build is driven by our relentless pursuit of perfection.

Premium Features

At Parker Torchology we do things differently, we strive to solve your problems with the perfect product to suit your needs. We create smart product features encased in cutting-edge design to ensure you always have the best tools to hand.





Production

A fusion of precision production engineering, our bespoke processing techniques and a fanatical attention to detail ensures every welding torch we produce is worthy of the Parker Torchology name.

Testing, Testing, Testing

It takes patience to develop a new product, it's a lot more than a great idea.

Product development is an iterative process, trying something over and over, changing one small variable at a time.

We build endless prototypes and test pieces that undergo months of rigorous testing. Only once a product has passed up to 88 different test procedures, with every single part tested separately do we consider our latest designs ready for market.

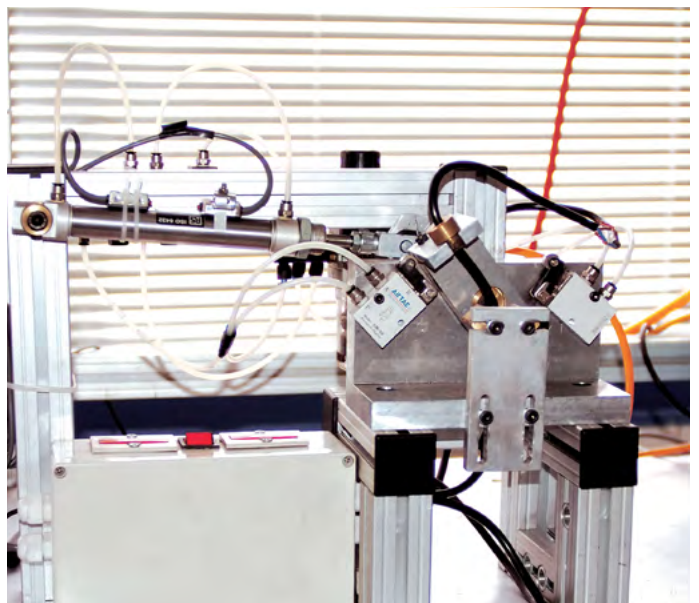

Partners

Our customers and business partners play a vital role in our development. With the core aim to strive together, we work with end users, distributors and academic institutions alike.

As a result we share fundamental values in order to succeed in our respective market places, supporting economic growth and collaborative opportunities with others.

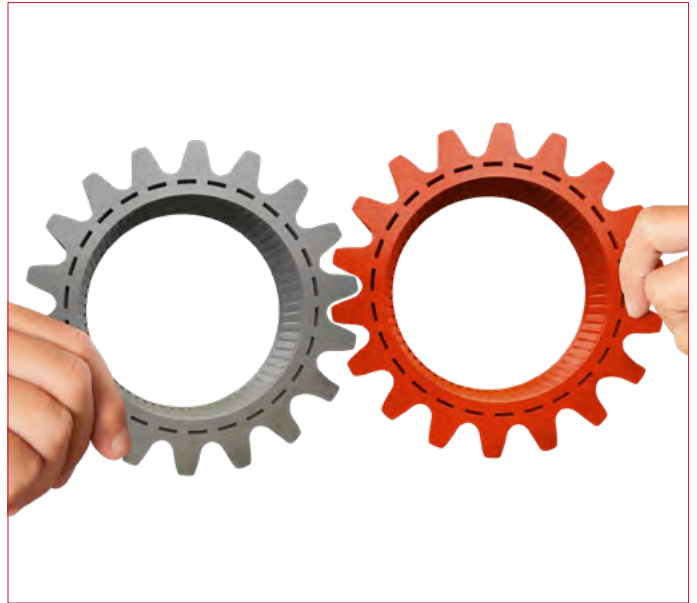

A Bright Future

Technology doesn't stand still, which is why we are constantly innovating to bring you the best products on the market.

Our strong vision and focused innovation strategy, not to mention our passion to revolutionize the industry, ensure that Parker Torchology is a byword for excellence.

We Talk Torches

Contents

	Fume Mig/Mag Torch Range Features Focus	6
	Fume Mig/Mag Torch Range Overview and Ratings	8
<hr/>		
	Torch Range	
	PX 150A	10
Air-Cooled	PX 250A	12
	PX 360A	14
Liquid-Cooled	PX 501W	16
<hr/>		
	Wear Parts	
	Fume Nozzles	18
	Nozzles	18
	Fume Adaptors	19
	Contact Tips	20
	Tip Adaptors	21
	Insulators	21
	Diffusers	21
	Liners	22
<hr/>		
	Air-Cooled Rear-End Spare Parts	25
	Liquid-Cooled Rear-End Spare Parts	25

Fume Mig/Mag Torch Range

The BZL Fume range has been designed with the welder in mind, offering powerful, consistent fume extraction coupled with high quality welds, what ever the job.

Advanced Fume Welding Torches for the Professional



Simple Airflow Control

Easily adjust the airflow with a handy slider, no matter how you hold the torch. Keeps things running smoothly by preventing fume buildup.

Clean, Consistent Welds

Wide-area suction and smart nozzle design helps keep the shielding gas stable so you can focus on getting the job done right.



Light and Manoeuvrable

Flexible hose and swivel joint reduces drag and help you move freely without the cable feeling heavy or stiff.

Features Focus

World Class Welding Performance



Comfort for Long Shifts

Balanced weight and a comfortable grip mean less wrist strain and better control, even on long jobs.

Clear Viewing

Designed to ensure a clear view of the workpiece.



Hassle-Free Maintenance

Quick to take apart and clean. Easily connects to fume extractors for cleaning while disassembled.



Fume Mig/Mag Torch Range

Ratings: 150 Amp to 450 Amp, Mixed Gas M21
IEC/EN 60974-7, ISO 21904-1



Model	PX 150A	PX 250A
Technical Data		
Cooling Method	Air-Cooled	Air-Cooled
Rating: CO ₂	180A	250A
Rating: Mixed Gas M21	150A	220A
Duty Cycle	60%	60%
Wire Size	0.6-1.0mm	0.8-1.2mm
Volume Flow Rate		
Extractor Nozzle	41 m ³ /h	48 m ³ /h
Connector	50.9 m ³ /h	56 m ³ /h
Pressure Drop	5.26 kPa	6.03 kPa
Efficiency	93%	93%
Shielding Gas Flow Rate	10-13 l/min	10-15 l/min
Weight	1.14kg/1mt	1.21kg/1mt
Order Codes		
3mt	PX150A-3M	PX250A-3M
4mt	PX150A-4M	PX250A-4M
5mt	PX150A-5M	PX250A-5M

Order Codes are for standard build with front leather cover only - please refer to individual pages for all build options

Fume Mig/Mag Torch Range

Ratings: 150 Amp to 450 Amp, Mixed Gas M21
IEC/EN 60974-7, ISO 21904-1



Model	PX 360A	PX 501W
Technical Data		
Cooling Method	Air-Cooled	Liquid-Cooled
Rating: CO ₂	300A	500A
Rating: Mixed Gas M21	270A	450A
Duty Cycle	60%	100%
Wire Size	0.9-1.2mm	0.9-1.6mm
Volume Flow Rate		
Extractor Nozzle	52 m ³ /h	52 m ³ /h
Connector	65 m ³ /h	66 m ³ /h
Pressure Drop	6.2 kPa	10 kPa
Efficiency	93%	93%
Shielding Gas Flow Rate	16-18 l/min	16-22 l/min
Minimum Liquid Flow Rate	-	1.5 l/min
Minimum Liquid Inlet Pressure	-	2.5 Bar
Minimum Cooling Requirements	-	1000W
Maximum Liquid Inlet Pressure	-	5.0 Bar
Maximum Liquid Inlet Temperature	-	50°C
Weight	1.37kg/1mt	1.37kg/1mt
Order Codes		
3mt	PX360A-3M	PX501W-3M
4mt	PX360A-4M	PX501W-4M
5mt	PX360A-5M	PX501W-5M

Order Codes are for standard build with front leather cover only - please refer to individual pages for all build options

PX 150A High Performance Mig Fume Torch Range

Rating: 180A CO₂, 150A mixed gas M21, EN60974-7 @ 60% duty cycle.0.6 to 1.0mm wires
Air-Cooled Mig Welding Torch

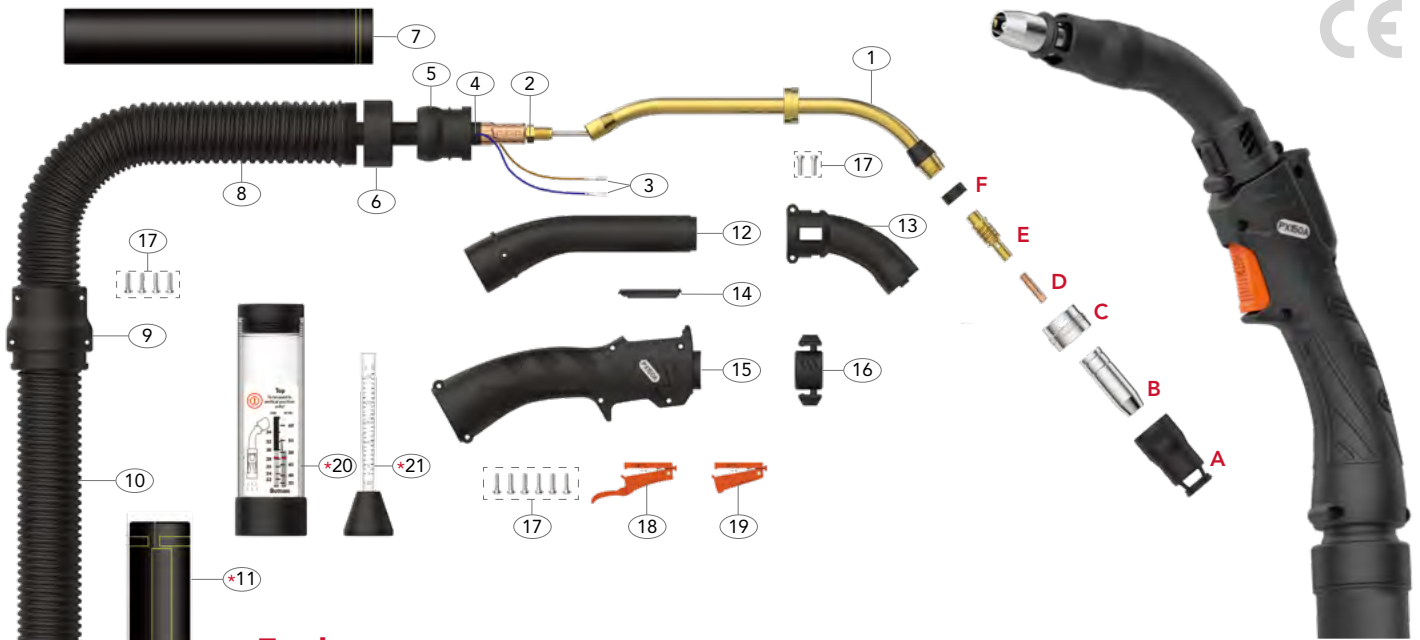

Torches

Description	Part No.		
	3mt	4mt	5mt
Fume Torch c/w Front Leather	PX150A-3M	PX150A-4M	PX150A-5M
Fume Torch c/w Front Leather, Air Flow and Gas Flow Meter	PX150A-3M-FM	PX150A-4M-FM	PX150A-5M-FM
Fume Torch Full Leather	PX150A-3M-LE	PX150A-4M-LE	PX150A-5M-LE
Fume Torch Full Leather c/w Air Flow and Gas Flow Meter	PX150A-3M-LE-FM	PX150A-4M-LE-FM	PX150A-5M-LE-FM

Wear Parts

A Fume Nozzles

Part No.	Description	Bore	Wall	Material
PBX1FN	Fume Nozzle	23.0	1.0mm	Aluminium

B Nozzles

Part No.	Description	Bore	Wall	Material
PB1529	Cylindrical Nozzle	16.0	0.9mm	Cu
*PB1530	Conical Nozzle	12.0	0.9mm	Cu
PB1531	Tapered Nozzle	10.5	0.9mm	Cu
PB1532	Bottle Nozzle	12.8	0.9mm	Cu
PB1533	Spot Welding Nozzle	16.0	0.9mm	Cu

C Fume Adaptors

Part No.	Description	Material
PBX1002	Fume Nozzle Adaptor	Aluminium

D Contact Tips

Part No.	Description	Material	Wire Size	
			mm	Inch
PB1527-06	Contact Tip	Cu	0.6	0.023"
*PB1527-08	Contact Tip	Cu	0.8	0.030"
PB1527-09	Contact Tip	Cu	0.9	0.035"
PB1527-10	Contact Tip	Cu	1.0	0.040"

E Tip Adaptors

Part No.	Description	Material
*PB1507LH	Tip Adaptor Left Hand	Brass

F Neck Insulator

Part No.	Description	Material
PBX1003	Neck Insulator	Aluminium

G Liners

Part No.	Description	Length	Wire Size
*PB1535-30	Steel Liner x 3mt	3.4mt	0.6-0.9
*PB1535-40	Steel Liner x 4mt	4.4mt	0.6-0.9
*PB1535-50	Steel Liner x 5mt	5.4mt	0.6-0.9

Volume Flow Rate

Extractor Nozzle	41 m ³ /h
Connector	50.9 m ³ /h

Pressure Drop 5.26 kPa

Efficiency 93%

Shielding Gas Flow 10-13 l/min

PX 150A High Performance Mig Fume Torch Range

Rating: 180A CO₂, 150A mixed gas M21, EN60974-7 @ 60% duty cycle.0.6 to 1.0mm wires

Air-Cooled Mig Welding Torch



Spare Parts

Part No.	Description
1	PBX1501 Swan Neck Assembly
2	PB1505 Lock Nut
3	PB1521 Cable Terminal
4	PBX1517-30 Power Cable Assembly x 3mt
	PBX1517-40 Power Cable Assembly x 4mt
	PBX1517-50 Power Cable Assembly x 5mt
5	PBX8015-1 Ball Joint
6	PBX8015-2 Ball Joint Nut
7	PXLC-30 x 1.5M Front Leather Cover 1.5mt
8	PBX4019-1 Front Extract Hose Assembly
9	PBX-HRC30-40 Hose Connector
10	PBX5019-2-30 Rear Extract Hose Assembly x 3mt
	PBX5019-2-40 Rear Extract Hose Assembly x 4mt
	PBX5019-2-50 Rear Extract Hose Assembly x 5mt
12	PBX3-IFC Inner Fume Chamber
13	PBX1-OFC Outer Fume Chamber
14	PB2514-C Handle Control Cover

Part No.	Description
15	PBX2514 Fume Handle Assembly
16	PBX3-AFR Air Flow Regulator
17	AXSP1-1 Screw Pack
18	PBX2516L Microswitch Extended Trigger
19	PBX2516 Microswitch Standard Trigger

Optional

*11	PXLC-40 x 0.75M	Rear Leather Cover 0.75mt
	PXLC-40 x 1.75M	Rear Leather Cover 1.75mt
	PXLC-40 x 2.75M	Rear Leather Cover 2.75mt
*20	PBX1-AFM	Air Flow Meter
*21	PBX-GFM	Gas Flow Meter

PX 250A High Performance Mig Fume Torch Range

Rating: 250A CO₂, 220A mixed gas M21, EN60974-7 @ 60% duty cycle. 0.8 to 1.2mm wires

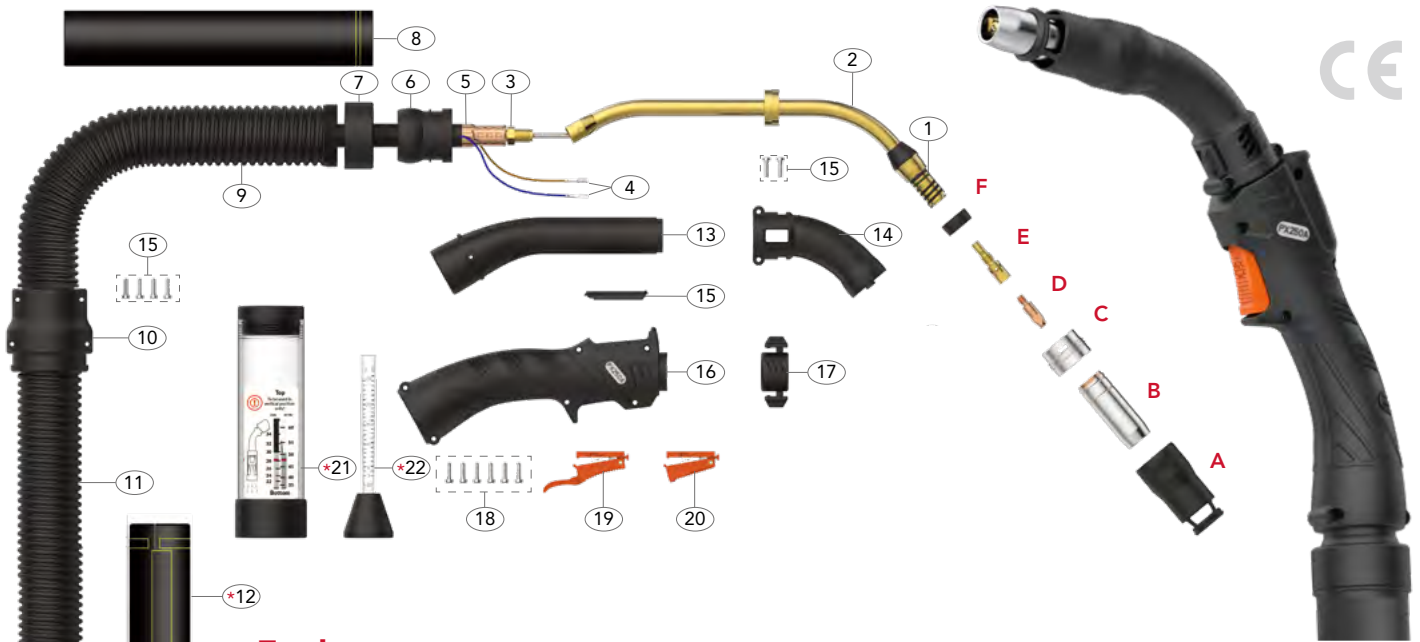

Torches

Description	Part No.		
	3mt	4mt	5mt
Fume Torch c/w Front Leather	PX250A-3M	PX250A-4M	PX250A-5M
Fume Torch c/w Front Leather, Air Flow and Gas Flow Meter	PX250A-3M-FM	PX250A-4M-FM	PX250A-5M-FM
Fume Torch Full Leather	PX250A-3M-LE	PX250A-4M-LE	PX250A-5M-LE
Fume Torch Full Leather c/w Air Flow and Gas Flow Meter	PX250A-3M-LE-FM	PX250A-4M-LE-FM	PX250A-5M-LE-FM

Wear Parts

A Fume Nozzles

Part No.	Description	Bore	Wall	Material
PBX2FN	Fume Nozzle	23.4	1.0mm	Aluminium

B Nozzles

Part No.	Description	Bore	Wall	Material
PB2507	Cylindrical Nozzle	18.0	1.5mm	Cu
*PB2508	Conical Nozzle	15.0	1.5mm	Cu
PB2509	Tapered Nozzle	12.0	1.5mm	Cu
PB2510	Bottle Nozzle	14.5	1.5mm	Cu
PB2511	Spot Welding Nozzle	18.0	1.5mm	Cu

C Fume Adaptors

Part No.	Description	Material
PBX2002	Fume Nozzle Adaptor	Aluminium

D Contact Tips M8

Part No.	Description	Material	Wire Size	
			mm	Inch
PB2504-08	Contact Tip	Cu	0.8	0.030"
*PB2504-10	Contact Tip	Cu	1.0	0.040"
PB2504-12	Contact Tip	Cu	1.2	0.045"
PB2504-10A	Contact Tip	Cu	1.0	0.040"
PB2504-12A	Contact Tip	Cu	1.2	0.045"

Part No.	Description	Material	Wire Size	
			mm	Inch
PB2505-08	Contact Tip	CuCrZr	0.8	0.030"
PB2505-10	Contact Tip	CuCrZr	1.0	0.040"
PB2505-12	Contact Tip	CuCrZr	1.2	0.045"
PB2505-10A	Contact Tip	CuCrZr	1.0	0.040"
PB2505-12A	Contact Tip	CuCrZr	1.2	0.045"

E Tip Adaptors

Part No.	Description	Material
*PB2506	Tip Adaptor	Brass
PB2536	Tip Adaptor M8	Brass

F Neck Insulator

Part No.	Description	Material
PBX2003	Neck Insulator	Aluminium

Volume Flow Rate

Extractor Nozzle	48 m ³ /h
Connector	56 m ³ /h
Pressure Drop	6.03 kPa
Efficiency	93%
Shielding Gas Flow	10-15 l/min

PX 250A High Performance Mig Fume Torch Range

Rating: 250A CO₂, 220A mixed gas M21, EN60974-7 @ 60% duty cycle.0.8 to 1.2mm wires

Air-Cooled Mig Welding Torch

Spare Parts

Part No.	Description
1	PBX2-NOR Neck'O'Ring
2	PBX2501 Swan Neck Assembly
3	PB1505 Lock Nut
4	PB1521 Cable Terminal
5	PBX2503-30 Power Cable Assembly x 3mt
	PBX2503-40 Power Cable Assembly x 4mt
	PBX2503-50 Power Cable Assembly x 5mt
6	PBX8015-1 Ball Joint
7	PBX8015-2 Ball Joint Nut
8	PXLC-30 x 1.5M Front Leather Cover 1.5mt
9	PBX4019-1 Front Extract Hose Assembly
10	PBX-HRC30-40 Hose Connector
11	PBX5019-2-30 Rear Extract Hose Assembly x 3mt
	PBX5019-2-40 Rear Extract Hose Assembly x 4mt
	PBX5019-2-50 Rear Extract Hose Assembly x 5mt
13	PBX3-IFC Inner Fume Chamber
14	PBX2-OFC Outer Fume Chamber
15	PB2514-C Handle Control Cover

Part No.	Description
16	PBX2514 Fume Handle Assembly
17	PBX3-AFR Air Flow Regulator
18	AXSP1-1 Screw Pack
19	PBX2516L Microswitch Extended Trigger
20	PBX2516 Microswitch Standard Trigger

Optional

*12	PXLC-40 x 0.75M	Rear Leather Cover 0.75mt
	PXLC-40 x 1.75M	Rear Leather Cover 1.75mt
	PXLC-40 x 2.75M	Rear Leather Cover 2.75mt
*21	PBX2-AFM	Air Flow Meter
*22	PBX-GFM	Gas Flow Meter

G Liners

Part No.	Description	Length	Wire Size mm
*PB2524-30	Steel Liner x 3mt	3.4mt	1.0-1.2
*PB2524-40	Steel Liner x 4mt	4.4mt	1.0-1.2
*PB2524-50	Steel Liner x 5mt	5.4mt	1.0-1.2

PX 360A High Performance Mig Fume Torch Range

Rating: 300A CO 2 , 270A mixed gas M21, EN60974-7 @ 60% duty cycle.0.9 to 1.2mm wires

Air-Cooled Mig Welding Torch

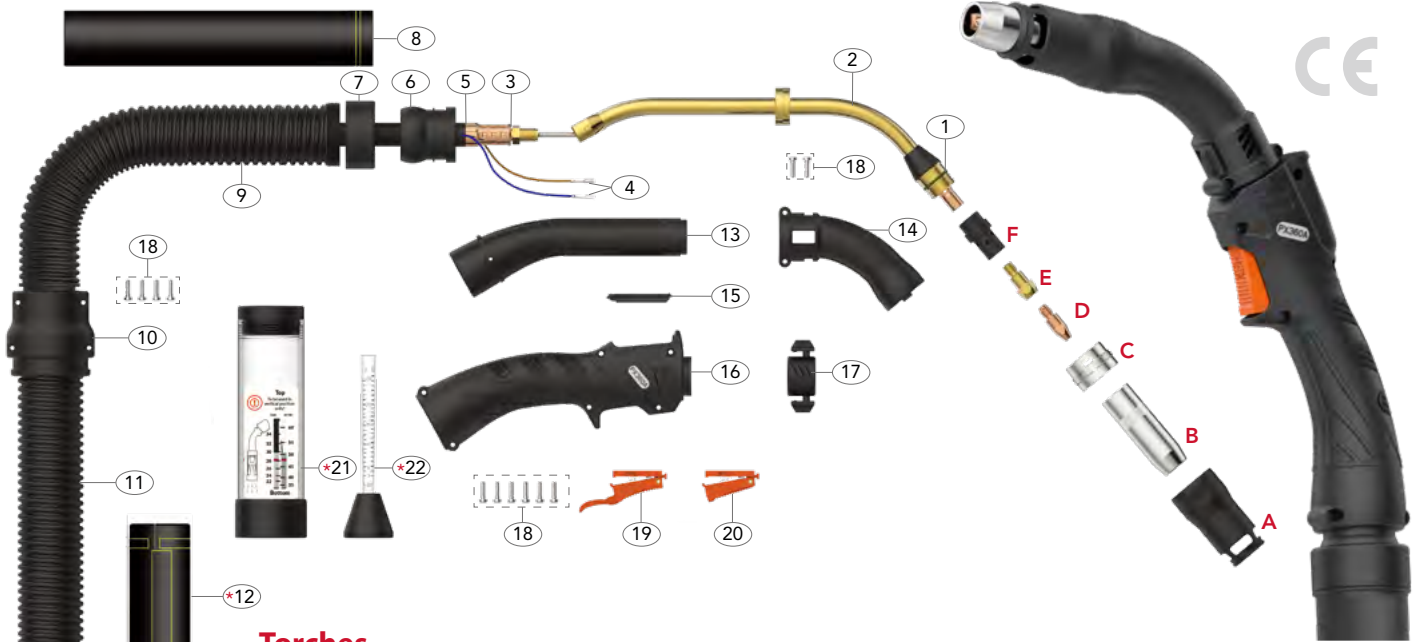

Torches

Description	Part No.		
	3mt	4mt	5mt
Fume Torch c/w Front Leather	PX360A-3M	PX360A-4M	PX360A-5M
Fume Torch c/w Front Leather, Air Flow and Gas Flow Meter	PX360A-3M-FM	PX360A-4M-FM	PX360A-5M-FM
Fume Torch Full Leather	PX360A-3M-LE	PX360A-4M-LE	PX360A-5M-LE
Fume Torch Full Leather c/w Air Flow and Gas Flow Meter	PX360A-3M-LE-FM	PX360A-4M-LE-FM	PX360A-5M-LE-FM

Wear Parts

A Fume Nozzles

Part No.	Description	Bore	Wall	Material
PBX3FN	Fume Nozzle	23.4	1.0mm	Aluminium

B Nozzles

Part No.	Description	Bore	Wall	Material
PBX3TN	Tapered Nozzle	12.0	2.5mm	Copper
*PBX3CN	Conical Nozzle	15.0	2.5mm	Copper
PBX3CYN	Cylindrical Nozzle	18.0	2.5mm	Copper

C Fume Adaptors

Part No.	Description	Material
PBX3002	Fume Nozzle Adaptor	Aluminium

D Contact Tips

Part No.	Description	Material	Wire Size	
			mm	Inch
PB2504-08	Contact Tip	Cu	0.8	0.030"
PB2504-10	Contact Tip	Cu	1.0	0.040"
PB2504-12	Contact Tip	Cu	1.2	0.045"
PB2504-10A	Contact Tip	Cu	1.0	0.040"
PB4014-08	Contact Tip	Cu	0.8	0.030"
PB4014-10	Contact Tip	Cu	1.0	0.040"
*PB4014-12	Contact Tip	Cu	1.2	0.045"

E Tip Adaptors

Part No.	Description	Material
PB3612	Tip Adaptor	Brass
PB3613	Tip Adaptor	Brass
*PB3614	Tip Adaptor	Brass

F Diffusers

Part No.	Description	Colour	Material
PB3605B	Diffuser	Black	DMC3
PB3605C	Diffuser	White	Ceramic
PB3605W	Diffuser	White	DMC3
*PB3605H	Diffuser	Black	HPP

G Liners

Part No.	Description	Length	Wire Size
			mm
*PB2524-30	Steel Liner x 3mt	3.4mt	1.0-1.2
*PB2524-40	Steel Liner x 4mt	4.4mt	1.0-1.2
*PB2524-50	Steel Liner x 5mt	5.4mt	1.0-1.2

Volume Flow Rate

Extractor Nozzle	52 m ³ /h
Connector	65 m ³ /h
Pressure Drop	6.2 kPa
Efficiency	93%
Shielding Gas Flow	16-18 l/min

PX 360A High Performance Mig Fume Torch Range

Rating: 300A CO 2 , 270A mixed gas M21, EN60974-7 @ 60% duty cycle.0.9 to 1.2mm wires

Air-Cooled Mig Welding Torch



Spare Parts

Part No.	Description
1	PBX3-NOR Neck'O'Ring
2	PBX3601 Swan Neck Assembly
3	PB1505 Lock Nut
4	PB1521 Cable Terminal
5	PBX3003-30 Power Cable Assembly x 3mt
	PBX3003-40 Power Cable Assembly x 4mt
	PBX3003-50 Power Cable Assembly x 5mt
6	PBX8015-1 Ball Joint
7	PBX8015-2 Ball Joint Nut
8	PXLC-32 x 1.5M Front Leather Cover 1.5mt
9	PBX5019-1 Front Extract Hose Assembly
10	PBX-HRC32-40 Hose Connector
11	PBX5019-2-30 Rear Extract Hose Assembly x 3mt
	PBX5019-2-40 Rear Extract Hose Assembly x 4mt
	PBX5019-2-50 Rear Extract Hose Assembly x 5mt
13	PBX3-IFC Inner Fume Chamber
14	PBX3-OFC Outer Fume Chamber
15	PB2514-C Handle Control Cover

Part No.	Description
16	PBX2514 Fume Handle Assembly
17	PBX3-AFR Air Flow Regulator
18	AXSP1-1 Screw Pack
19	PBX2516L Microswitch Extended Trigger
20	PBX2516 Microswitch Standard Trigger

Optional

*12	PXLC-40 x 0.75M	Rear Leather Cover 0.75mt
	PXLC-40 x 1.75M	Rear Leather Cover 1.75mt
	PXLC-40 x 2.75M	Rear Leather Cover 2.75mt
*21	PBX3-AFM	Air Flow Meter
*22	PBX-GFM	Gas Flow Meter

PX 501W High Performance Mig Fume Torch Range

Rating: 500A CO 2 , 450A mixed gas M21, EN60974-7 @ 100% duty cycle.0.9 to 1.6mm wires

Liquid-Cooled Mig Welding Torch

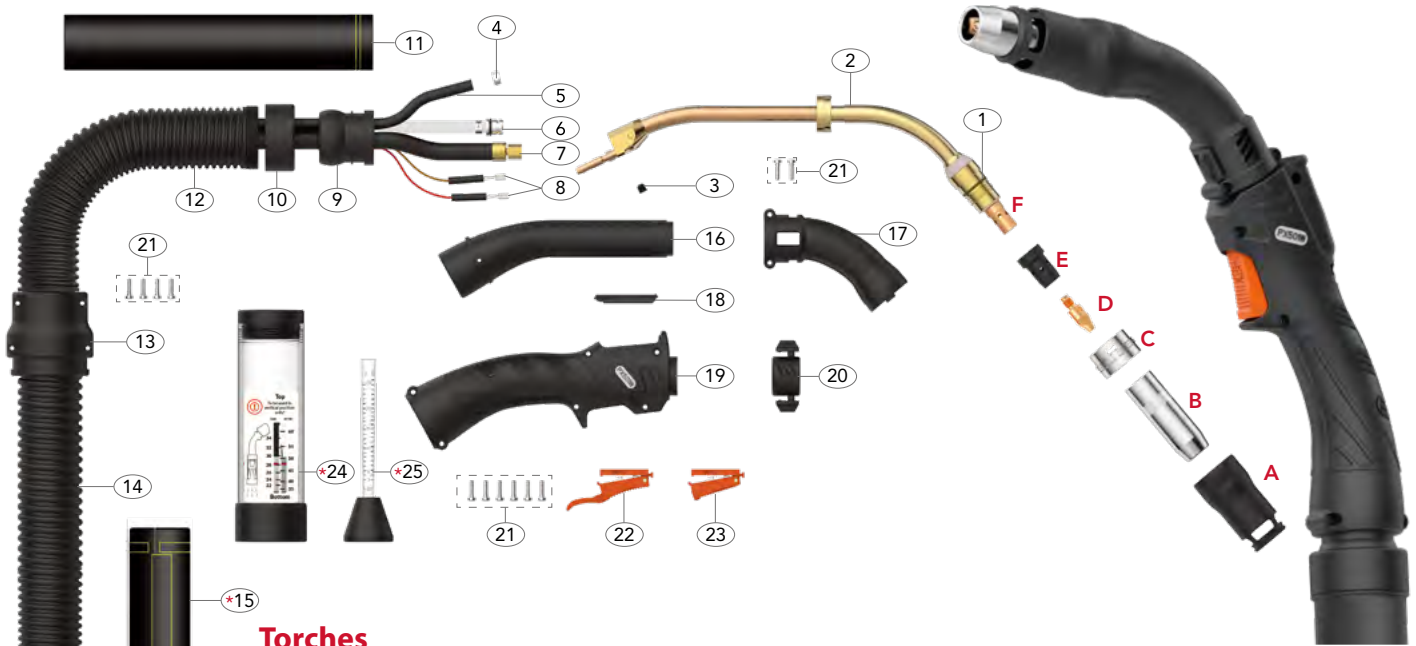

Torches

Description	Part No.		
	3mt	4mt	5mt
Fume Torch c/w Front Leather	PX501W-3M	PX501WA-4M	PX501W-5M
Fume Torch c/w Front Leather, Air Flow and Gas Flow Meter	PX501W-3M-FM	PX501WA-4M-FM	PX501W-5M-FM
Fume Torch Full Leather	PX501W-3M-LE	PX501W-4M-LE	PX501W-5M-LE
Fume Torch Full Leather c/w Air Flow and Gas Flow Meter	PX501W-3M-LE-FM	PX501W-4M-LE-FM	PX501W-5M-LE-FM

Wear Parts

A Fume Nozzles

Part No.	Description	Bore	Wall	Material
PBX3FN	Fume Nozzle	23.4	1.0mm	Aluminium

B Nozzles

Part No.	Description	Bore	Wall	Material
PBX3TN	Tapered Nozzle	12.0	2.5mm	Copper
*PBX3CN	Conical Nozzle	15.0	2.5mm	Copper
PBX3CYN	Cylindrical Nozzle	18.0	2.5mm	Copper

C Fume Adaptors

Part No.	Description	Material
PBX3002	Fume Nozzle Adaptor	Aluminium

D Contact Tips

Part No.	Description	Material	Wire Size	
			mm	Inch
PB4014-10	Contact Tip	Cu	1.0	0.040"
PB4014-12	Contact Tip	Cu	1.2	0.045"
PB4014-16	Contact Tip	Cu	1.6	0.063"
*PB4015-12	Contact Tip	CuCrZr	1.2	0.045"
PB4015-16	Contact Tip	CuCrZr	1.6	0.063"

E Diffusers

Part No.	Description	Colour	Material
PB5005B	Diffuser	Black	DMC3
PB5005C	Diffuser	White	Ceramic
PB5005W	Diffuser	White	DMC3
*PB5005H	Diffuser	Black	HPP

F Tip Adaptors

Part No.	Description	Material
PB5001	Tip Adaptor	Brass
*PB5001C	Tip Adaptor	CuCrZr
PB5001L	Tip Adaptor Long	Brass

G Liners

Part No.	Description	Length	Wire Size
			mm
*PB2524-30	Steel Liner x 3mt	3.4mt	1.0-1.2
*PB2524-40	Steel Liner x 4mt	4.4mt	1.0-1.2
*PB2524-50	Steel Liner x 5mt	5.4mt	1.0-1.2

Volume Flow Rate

Extractor Nozzle	52 m ³ /h
Connector	66 m ³ /h
Pressure Drop	10 kPa
Efficiency	93%
Shielding Gas Flow	16-22 l/min

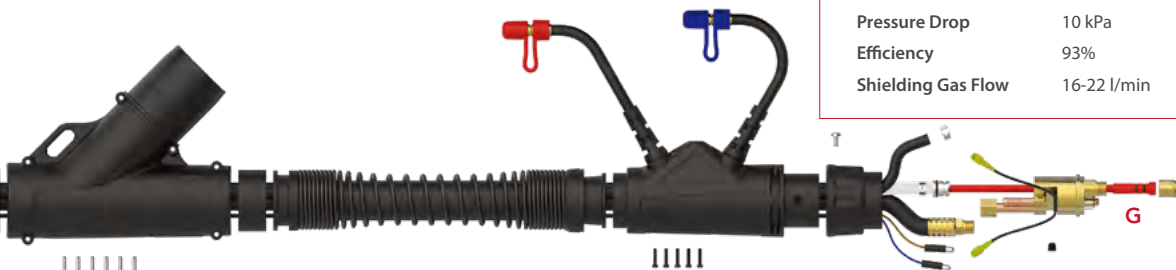

PX 501W High Performance Mig Fume Torch Range

Rating: 500A CO 2 , 450A mixed gas M21, EN60974-7 @ 100% duty cycle.0.9 to 1.6mm wires

Liquid-Cooled Mig Welding Torch



Spare Parts

Part No.	Description
1	PBX3-NOR Neck'O'Ring
2	PBX5002 Swan Neck Assembly
3	PAM6X5 Outer Liner Retaining Screw
4	15400023 Water Hose Clamp 10mm
9	PBX8015-1 Ball Joint
10	PBX8015-2 Ball Joint Nut
11	PBXLC-32 x 1.5M Front Leather Cover 1.5mt
12	PBX5019-1 Front Extract Hose Assembly
13	PBX-HRC32-40 Hose Connector
16	PBX3-IFC Inner Fume Chamber
17	PBX3-OFC Outer Fume Chamber
18	PB2514-C Handle Control Cover
19	PBX2514 Fume Handle Assembly

Part No.	Description
20	PBX3-AFR Air Flow Regulator
21	AXSP1-1 Screw Pack
22	PBX2516L Microswitch Extended Trigger
23	PBX2516 Microswitch Standard Trigger

Optional

*15	PXLC-40 x 0.75M	Rear Leather Cover 0.75mt
	PXLC-40 x 1.75M	Rear Leather Cover 1.75mt
	PXLC-40 x 2.75M	Rear Leather Cover 2.75mt
*24	PBX3-AFM	Air Flow Meter
*25	PBX-GFM	Gas Flow Meter

Cable Parts

Description	Part No.		
	3mt	4mt	5mt
5 Water Inlet Hose Assembly	PBX5012-30	PBX5012-40	PBX5012-50
6 Outer Liner Assembly	PBX5008-30	PBX5008-40	PBX5008-50
7 Power Cable Assembly	PBX5015-30	PBX5015-40	PBX5015-50
8 Switch Lead Assembly	PBX5010-30	PBX5010-40	PBX5010-50
14 Rear Extract Hose Assembly	PBX5019-2-30	PBX5019-2-40	PBX5019-2-50

Fume Nozzles

PX 150A

Part No.	Description	Wall	Material
PBX1FN	Fume Nozzle	1.0mm	Aluminium

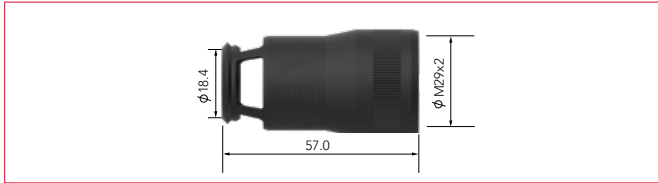

PX 250A

Part No.	Description	Wall	Material
PBX2FN	Fume Nozzle	1.0mm	Aluminium

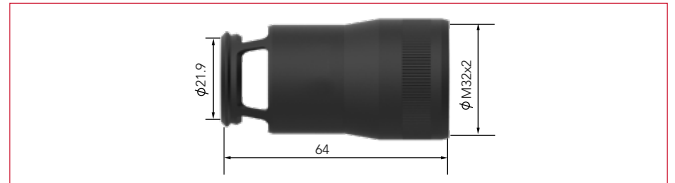

PX 360A/501W

Part No.	Description	Wall	Material
PBX3FN	Fume Nozzle	1.0mm	Aluminium

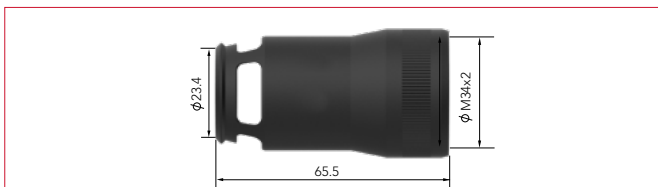

Nozzles

PX 150A

Part No.	Description	Bore	Wall	Material
PB1529	Cylindrical Nozzle	16.0	0.9mm	Cu
*PB1530	Conical Nozzle	12.0	0.9mm	Cu
PB1531	Tapered Nozzle	10.5	0.9mm	Cu
PB1532	Bottle Nozzle	12.8	0.9mm	Cu
PB1533	Spot Welding Nozzle	16.0	0.9mm	Cu

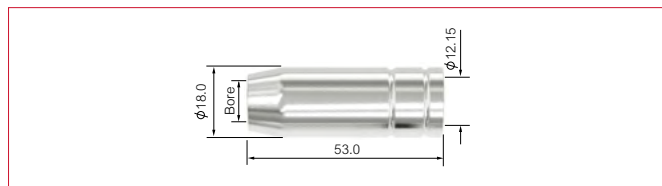

PX 250A

Part No.	Description	Bore	Wall	Material
PB2507	Cylindrical Nozzle	18.0	1.5mm	Cu
*PB2508	Conical Nozzle	15.0	1.5mm	Cu
PB2509	Tapered Nozzle	12.0	1.5mm	Cu
PB2510	Bottle Nozzle	14.5	1.5mm	Cu
PB2511	Spot Welding Nozzle	18.0	1.5mm	Cu



PX 360A/501W

Part No.	Description	Bore	Wall	Material
PBX3TN	Tapered Nozzle	12.0	2mm	Copper
*PBX3CN	Conical Nozzle	16.0	2mm	Copper
PBX3CYN	Cylindrical Nozzle	19.0	2mm	Copper

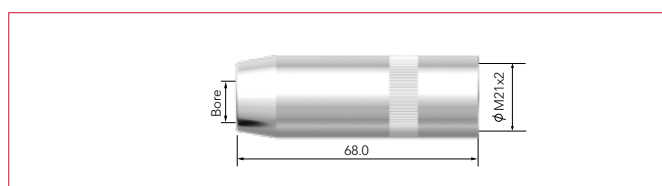

Wear Parts

Fume Adaptors

PX 150A

Part No.	Description	Material
PBX1002	Fume Nozzle Adaptor	Aluminium

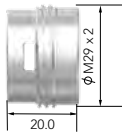

PX 250A

Part No.	Description	Material
PBX2002	Fume Nozzle Adaptor	Aluminium

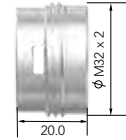

PX 360A/501W

Part No.	Description	Material
PBX3002	Fume Nozzle Adaptor	Aluminium

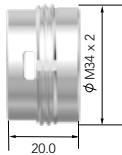

Contact Tips

PX 150A

Part No.	Description	Material	Wire Size	
			mm	inch
PB1527-06	Contact Tip	Cu	0.6	0.023
* PB1527-08	Contact Tip	Cu	0.8	0.030
PB1527-09	Contact Tip	Cu	0.9	0.035
PB1527-10	Contact Tip	Cu	1.0	0.040
PB1527-12	Contact Tip	Cu	1.2	0.045

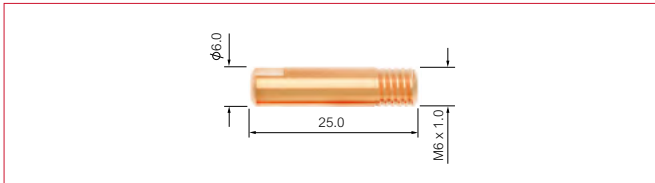

PX 250A/360A

Part No.	Description	Material	Wire Size	
			mm	inch
PB2504-06	Contact Tip	Cu	0.6	0.023
PB2504-08	Contact Tip	Cu	0.8	0.030
PB2504-09	Contact Tip	Cu	0.9	0.035
* PB2504-10	Contact Tip	Cu	1.0	0.040
PB2504-12	Contact Tip	Cu	1.2	0.045
PB2504-14	Contact Tip	Cu	1.4	0.055
PB2504-16	Contact Tip	Cu	1.6	0.063
PB2504-10A	Contact Tip	Cu	1.0	0.040
PB2504-12A	Contact Tip	Cu	1.2	0.045
PB2504-16A	Contact Tip	Cu	1.6	0.063

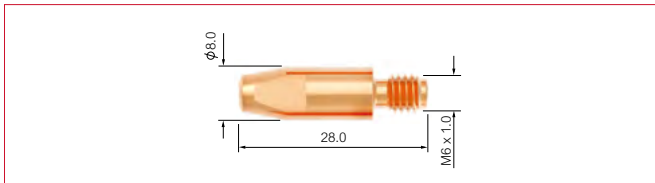

PB2505-08	Contact Tip	CuCrZr	0.8	0.030
PB2505-09	Contact Tip	CuCrZr	0.9	0.035
PB2505-10	Contact Tip	CuCrZr	1.0	0.040
PB2505-12	Contact Tip	CuCrZr	1.2	0.045
PB2505-16	Contact Tip	CuCrZr	1.6	0.063
PB2505-10A	Contact Tip	CuCrZr	1.0	0.040
PB2505-12A	Contact Tip	CuCrZr	1.2	0.045
PB2505-16A	Contact Tip	CuCrZr	1.6	0.063

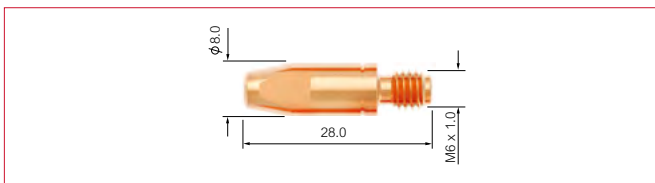

PX 360A/501W

Part No.	Description	Material	Wire Size	
			mm	inch
PB4014-08	Contact Tip	Cu	0.8	0.030
PB4014-09	Contact Tip	Cu	0.9	0.035
PB4014-10	Contact Tip	Cu	1.0	0.040
PB4014-12	Contact Tip	Cu	1.2	0.045
PB4014-14	Contact Tip	Cu	1.4	0.055
PB4014-16	Contact Tip	Cu	1.6	0.063
PB4014-20	Contact Tip	Cu	2.0	0.080
PB4014-24	Contact Tip	Cu	2.4	0.095
PB4014-10A	Contact Tip	Cu	1.0	0.040
PB4014-12A	Contact Tip	Cu	1.2	0.045
PB4014-16A	Contact Tip	Cu	1.6	0.063

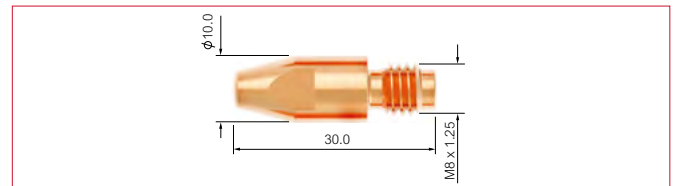

PB4015-08	Contact Tip	CuCrZr	0.8	0.030
PB4015-09	Contact Tip	CuCrZr	0.9	0.035
PB4015-10	Contact Tip	CuCrZr	1.0	0.040
* PB4015-12	Contact Tip	CuCrZr	1.2	0.045
PB4015-13	Contact Tip	CuCrZr	1.3	0.052
PB4015-14	Contact Tip	CuCrZr	1.4	0.055
PB4015-16	Contact Tip	CuCrZr	1.6	0.063
PB4015-20	Contact Tip	CuCrZr	2.0	0.080
PB4015-24	Contact Tip	CuCrZr	2.4	0.095
PB4015-10A	Contact Tip	CuCrZr	1.0	0.040
PB4015-12A	Contact Tip	CuCrZr	1.2	0.045
PB4015-16A	Contact Tip	CuCrZr	1.6	0.063

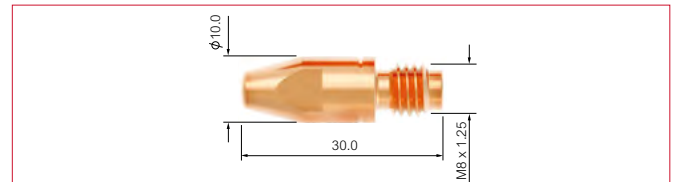

* Denotes torch package standard wear part set-up

Wear Parts

Tip Adaptors

PX 150A

Part No.	Description	Material
*PB1507L\H	Tip Adaptor Left Hand	Brass

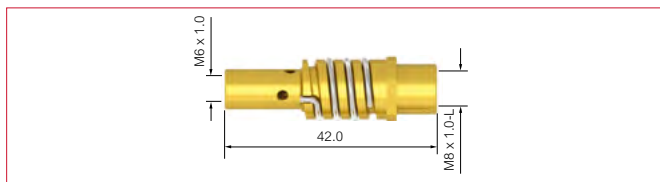

PX 360A

Part No.	Description	Material
PB3612	Tip Adaptor 28.5mm M6	Brass
PB3613	Tip Adaptor 31.5mm M6	Brass
*PB3614	Tip Adaptor 28.5mm M8	Brass

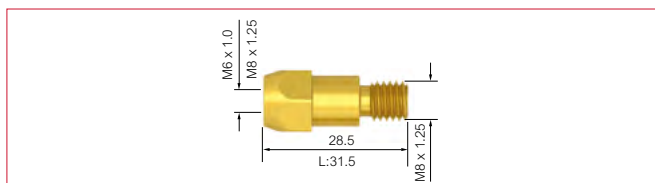

PX 250A

Part No.	Description	Material
*PB2506	Tip Adaptor	Brass

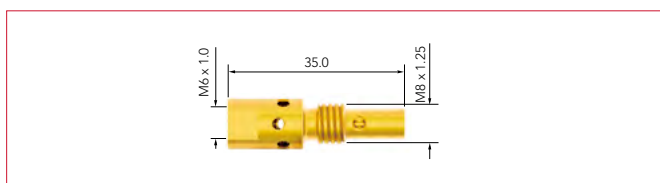

PX 501W

Part No.	Description	Material
PB5001	Tip Adaptor 25mm M6	Brass
*PB5001C	Tip Adaptor 28mm M8	CuCrZr
PB5001L	Tip Adaptor Long	Brass

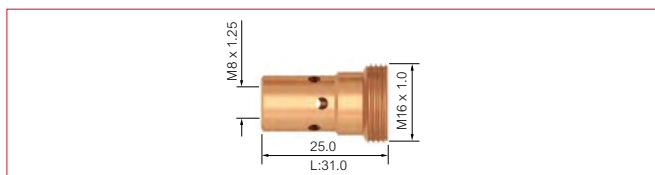

Insulators

PX 150A

Part No.	Description
PBX1003	Neck Insulator



PX 1250A

Part No.	Description
PBX2003	Neck Insulator



Diffusers

PX 360A

Part No.	Description	Colour	Material
PB3605B	Diffuser	Black	DMC3
PB3605C	Diffuser	White	Ceramic
PB3605W	Diffuser	White	DMC3
*PB3605H	High Performance	Black	HPP

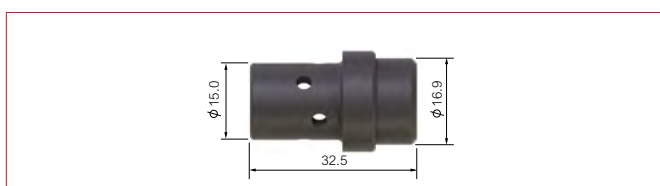

PX501W

Part No.	Description	Colour	Material
PB5005B	Diffuser	Black	DMC3
PB5005C	Diffuser	White	Ceramic
PB5005W	Diffuser	White	DMC3
*PB5005H	High Performance	Black	HPP

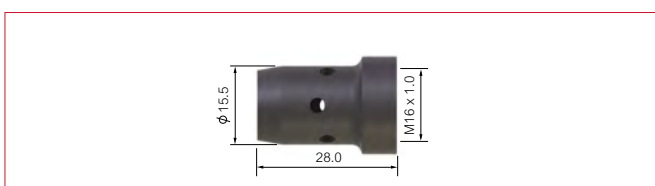

Liner Options 0.6-1.2mm

PX 150A/250A/360A

Part No.	Description	Length	Nipple	Wire Size mm
* PB1535-30	Steel Liner x 3mt	3.4mt	Moulded Nipple	0.6-0.9
* PB1535-40	Steel Liner x 4mt	4.4mt	Moulded Nipple	0.6-0.9
* PB1535-50	Steel Liner x 5mt	5.4mt	Moulded Nipple	0.6-0.9

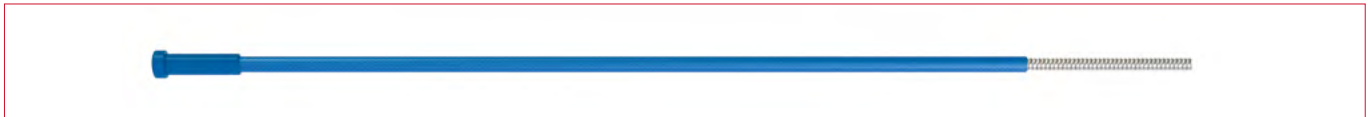

PB1535-30B	Steel Liner x 3mt	3.4mt	Brass Nipple	0.6-0.9
PB1535-40B	Steel Liner x 4mt	4.4mt	Brass Nipple	0.6-0.9
PB1535-50B	Steel Liner x 5mt	5.4mt	Brass Nipple	0.6-0.9

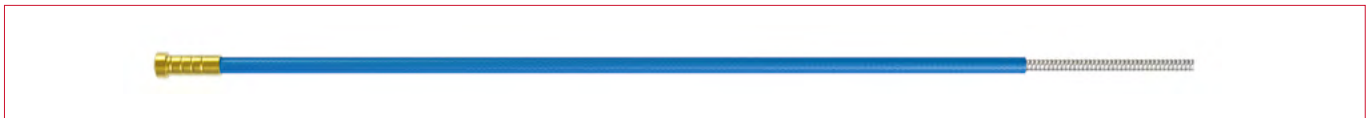

PB1536-30	Teflon Liner x 3mt	3.6mt	Brass Nipple	0.6-0.9
PB1536-40	Teflon Liner x 4mt	4.6mt	Brass Nipple	0.6-0.9
PB1536-50	Teflon Liner x 5mt	5.6mt	Brass Nipple	0.6-0.9
PNE1564	Optional Brass Neck Liner	0.3mt	Brass Nipple	0.8-1.2



PB1564-30	Polyamide/Brass Liner x 4.0mm O/D x 3mt	3.6mt	Brass Nipple	0.8-1.2
PB1564-40	Polyamide/Brass Liner x 4.0mm O/D x 4mt	4.6mt	Brass Nipple	0.8-1.2
PB1564-50	Polyamide/Brass Liner x 4.0mm O/D x 5mt	5.6mt	Brass Nipple	0.8-1.2



Wear Parts

Liner Options 1.0-1.2mm

PX 250A/360A/501W

Part No.	Description	Length	Nipple	Wire Size mm
* PB2524-30	Steel Liner x 3mt	3.4mt	Moulded Nipple	1.0-1.2
* PB2524-40	Steel Liner x 4mt	4.4mt	Moulded Nipple	1.0-1.2
* PB2524-50	Steel Liner x 5mt	5.4mt	Moulded Nipple	1.0-1.2



PBX2524-30B	Steel Liner x 3mt	3.4mt	Brass Nipple	1.0-1.2
PBX2524-40B	Steel Liner x 4mt	4.4mt	Brass Nipple	1.0-1.2
PBX2524-50B	Steel Liner x 5mt	5.4mt	Brass Nipple	1.0-1.2



PB2564-30	Polyamide/Brass Liner x 4.7mm O/D x 3mt	3.6mt	Brass Nipple	1.2-1.6
PB2564-40	Polyamide/Brass Liner x 4.7mm O/D x 4mt	4.6mt	Brass Nipple	1.2-1.6
PB2564-50	Polyamide/Brass Liner x 4.7mm O/D x 5mt	5.6mt	Brass Nipple	1.2-1.6



Liner Options 1.2-1.6mm

PX 501W

Part No.	Description	Length	Nipple	Wire Size mm
PB3631-30	Steel Liner x 3mt	3.4mt	Moulded Nipple	1.6
PB3631-40	Steel Liner x 4mt	4.4mt	Moulded Nipple	1.6
PB3631-50	Steel Liner x 5mt	5.4mt	Moulded Nipple	1.6



PB3631-30B	Steel Liner x 3mt	3.4mt	Brass Nipple	1.6
PB3631-40B	Steel Liner x 4mt	4.4mt	Brass Nipple	1.6
PB3631-50B	Steel Liner x 5mt	5.4mt	Brass Nipple	1.6



Liner Options 1.2-2.0mm

PX 501W

Part No.	Description	Length	Nipple	Wire Size mm
PB3626-30	Teflon Liner x 3mt	3.6mt	Brass Nipple	1.2-1.6
PB3626-40	Teflon Liner x 4mt	4.6mt	Brass Nipple	1.2-1.6
PB3626-50	Teflon Liner x 5mt	5.6mt	Brass Nipple	1.2-1.6
PNE2564	Optional Brass Neck Liner	0.3mt	Brass Nipple	1.2-1.6

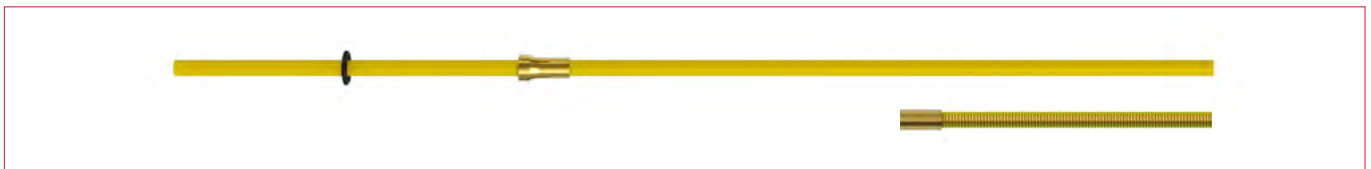

Air-Cooled Rear-End Spare Parts

PX 150A

PX 250A

PX 360A

Part No.	Part No.	Part No.	Description
1	PBX1522	PBX1522	Cable Terminal Male
2	PBX1505	PBX1505	Lock Nut
3	PBXSP1-1	PBXSP1-1	Screw Pack
4	PBX-YC	PBX-YC	Y' Connector
5	PBX1-SR	PBX2-SR	Sponge Seal Ring
6	PBX5019-CS	PBX5019-CS	Connect Spring Assembly
7	PMSP1-1	PMSP1-1	Screw Pack
8	PBX5022	PBX5022	Housing Assembly
9	PBL1541	PBL1541	Gun Plug Screw
10	PB1519	PB1519	Gun Plug Nut
11	PB1524	PB1524	Gun Plug 'O' Ring
12	PB1525	PB1525	Liner Nut

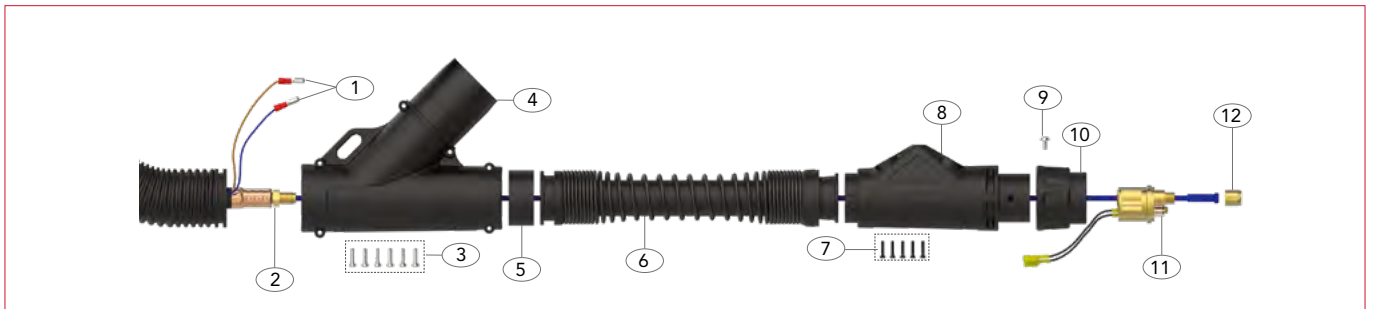

Liquid-Cooled Rear-End Spare Parts

PX 501W

Part No.	Description
1	PBX-YC
2	PBXSP1-1
3	PBX5-SR
4	PBX5019-CS
5	PBX1820
6	PBX5017
7	PBD_80320
8	PBD_80310
9	PMSP1-1
10	PB1526
11	15400023
12	PBX5098
13	PM6X5
14	PB1525

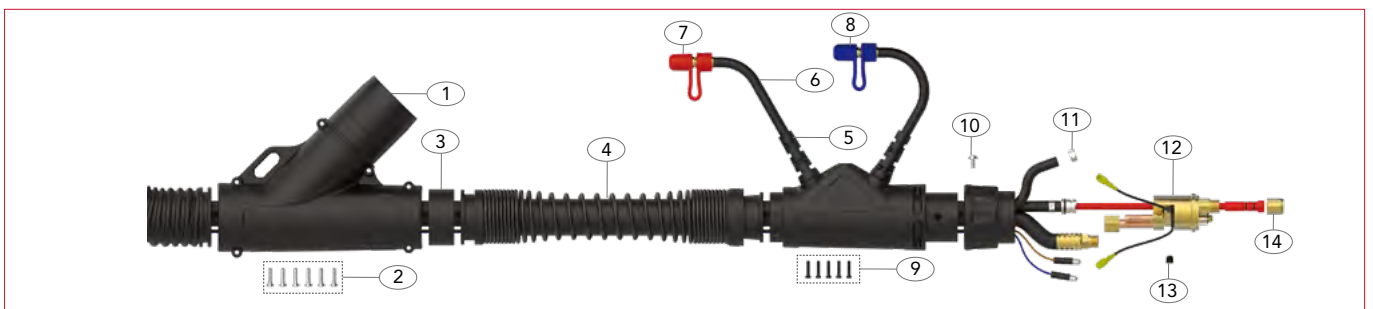



Floor 1 & 2, No.358, Gang Xing Er Road
Jinan Area of China (Shandong) Pilot Free Trade Zone
Jinan 250102
P.R. China

Tel: +86 531 88239823
Fax: +86 531 88239398
Website: www.parkertorchology.com
Email: info@parkertorchology.com
V.2025.11